

S4 Power-PCB-Relay 2 pole 10 A



Technical data

Contact data		
Type of contact		Single contact
Pinning	mm	5,0
Configuration		2 CO / 2 NO
Rated voltage/max. breaking voltage	VAC	250 / 440
Rated current	A	10
Make current (max. 5s)	A	17
Rated breaking capacity (cos φ = 1)	VA / W	2500 / 250
Contact resistance	mΩ	≤ 50
Contact material		AgCdO / AgNi 0,15 hv

General data		
Mechanical life	>Operations	30 x 10 ⁶
Electrical life at rated voltage	>Operations	1 x 10 ⁵
Max. Switching rate at rated voltage	Operations / h	900
Operate time / Release time	Approx.ms	8 / 5
Dielectric strength contacts / coil	≥ VAC _{rms}	4000
Dielectric strength open contacts	≥ VAC _{rms}	1000
Clearance / creepage	mm	> 8 / 8
Insulation group		C / 250
Ambient temperature	°C	-40...+ 85
Position		Any
Solder bath temperature/-duration	°C / sec	260 / 10
Approvals		VDE, UL, CSA, S, N, D, Fi

Coil data at + 20°C		
Nominal voltage	VDC	5...110
Nominal coil power	Approx. W	0,5
Operate power	Approx. W	0,25..0,30
Pull-in voltage	% of U _N	≤ 70
Drop-out voltage	% of U _N	≥ 10

U _N (VDC)	R (Ohm)	U _{PI} (VDC)	U _{DO} (VDC)	I _N (mA)
5	50 ± 10 %	≤ 3,5	≥ 0,5	100,0
6	70 ± 10 %	≤ 4,2	≥ 0,6	85,7
12	270 ± 10 %	≤ 8,5	≥ 1,2	44,5
24	1.100 ± 10 %	≤ 17,0	≥ 2,4	21,8
36	2.500 ± 10 %	≤ 25,5	≥ 3,6	14,4
48	4.300 ± 15 %	≤ 34,0	≥ 4,8	11,2
60	6.000 ± 15 %	≤ 42,6	≥ 6,0	10,0
110	23.200 ± 15 %	≤ 77,0	≥ 11,0	4,7



Dimensions

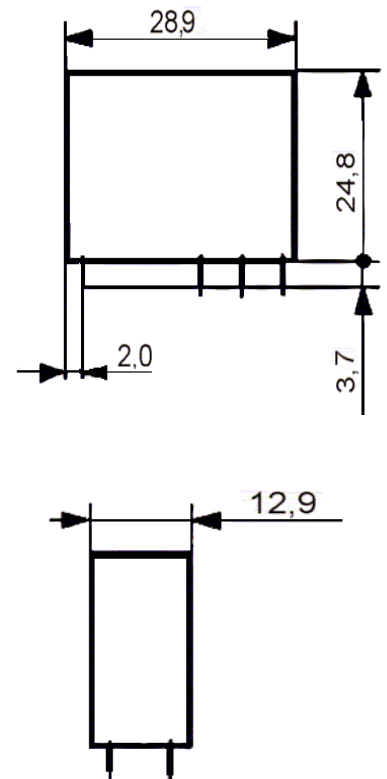

Wiring / PCB-layout

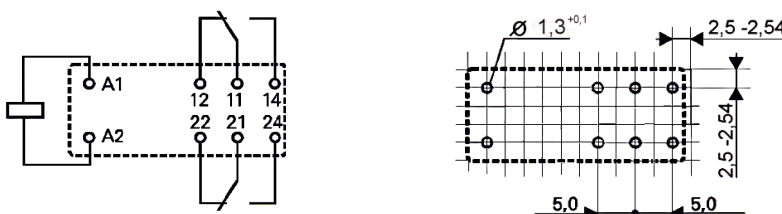

S4 Power-PCB-Relay 2 pole 10 A



Ordering key

1.	2.	3.	4.	5.	6.	7.
S4	0	0	2	B	2	4

Character 1	Type	S4 = Vertical				
Character 2 till 4	Configuration	0 = Number of	NO			
		0 = Number of	NC			
		2 = Number of	CO			
Stelle 5	Kontaktmaterial	A = AgNi 0,15 hv				
		B = AgCdO				
Stelle 6 bis 7	Spulenspannung	05 = 5 VDC	06 = 6 VDC	12 = 12 VDC	24 = 24 VDC	
		36 = 36 VDC	48 = 48 VDC	60 = 60 VDC	79 = 110 VDC	

Bold = Standard types – further details on request

Ordering key, example: S4 002 B 24

Power-PCB-Relay, vertical 2 CO, AgCdO, 24 VDC coil

Relay S4 is not suitable for plug into standard sockets

Electrical Specifications

